



## LOCKNUT-SOCKET-KM0 [↗](#)

Groove nut socket wrench

for locknuts and precision locknuts

### Información técnica

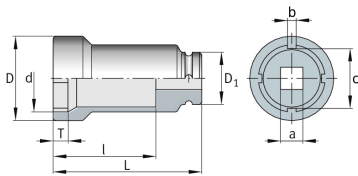

#### Medidas

d	18,3 mm	
D	22 mm	
D <sub>1</sub>	22 mm	
L	57 mm	
I	45 mm	
T	5 mm	
a	3/8"	Square (inch)
b	2,6 mm	
c	14,4 mm	
≈m	0,1 kg	Peso

#### Información adicional

KM0	Suitable for locknuts
ZM10	Suitable for precision locknuts
1 pc. socket wrench with locking pin and rubber washer	Included in delivery