



## LOCKNUT-HOOK-KM17 [↗](#)

Locknut hook wrench

for locknuts KM



### Información técnica

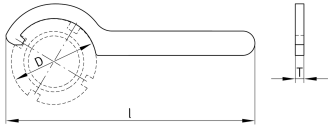

#### Variante de su producto actual

Version	SW	Single wrench
---------	----	---------------

#### Medidas

D <sub>min</sub>	110 mm	
D <sub>max</sub>	115 mm	
l	335 mm	
T	10 mm	
m	0,745 kg	Peso

#### Información adicional

1 pc. hook wrench	Scope of delivery
—	Part of LOCKNUT-HOOK-KM0-16-SET
KM17	Suitable for locknuts