



LOCKNUT-HOOK-KM28-30 [↗](#)

Locknut hook wrench

for locknuts KM



Información técnica

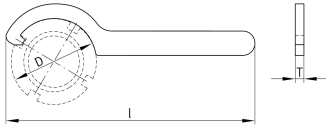

Variante de su producto actual

Version	SW	Single wrench
---------	----	---------------

Medidas

D _{min}	180 mm	
D _{max}	195 mm	
l	470 mm	
T	10 mm	
m	1,5 kg	Peso

Información adicional

1 pc. hook wrench	Scope of delivery
—	Part of LOCKNUT-HOOK-KM0-16-SET
KM28, KM29, KM30	Suitable for locknuts