



LOCKNUT-HOOK-KM8-9 [↗](#)

Locknut hook wrench

for locknuts KM



Información técnica

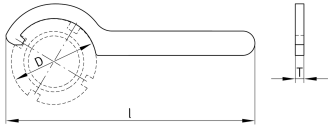

Variante de su producto actual

Version	SW	Single wrench
---------	----	---------------

Medidas

D _{min}	58 mm	
D _{max}	62 mm	
l	240 mm	
T	7 mm	
m	0,26 kg	Peso

Información adicional

1 pc. hook wrench	Scope of delivery
+	Part of LOCKNUT-HOOK-KM0-16-SET
KM8, KM9	Suitable for locknuts