



LOCKNUT-SOCKET-KM1 [↗](#)

Groove nut socket wrench

for locknuts and precision locknuts

Información técnica

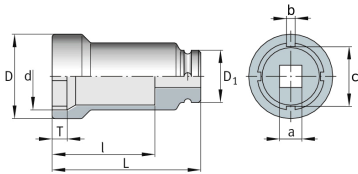

Medidas

d	22,4 mm	
D	28 mm	
D ₁	22 mm	
L	57 mm	
I	45 mm	
T	5 mm	
a	3/8"	Square (inch)
b	2,6 mm	
c	18,5 mm	
≈m	0,1 kg	Peso

Información adicional

KM1	Suitable for locknuts
ZM12	Suitable for precision locknuts
1 pc. socket wrench with locking pin and rubber washer	Included in delivery