



LOCKNUT-SOCKET-KM2 [🔗](#)

Groove nut socket wrench

for locknuts and precision locknuts

Información técnica

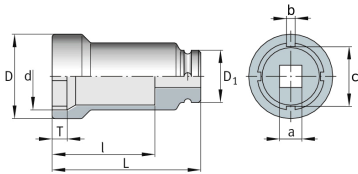

Medidas

d	25,4 mm	
D	33 mm	
D ₁	30 mm	
L	82 mm	
I	65 mm	
T	6 mm	
a	1/2"	Square (inch)
b	3,5 mm	
c	21,6 mm	
≈m	0,2 kg	Peso

Información adicional

KM2	Suitable for locknuts
1 pc. socket wrench with locking pin and rubber washer	Included in delivery