



LOCKNUT-SOCKET-KM6 [↗](#)

Groove nut socket wrench

for locknuts and precision locknuts

Información técnica

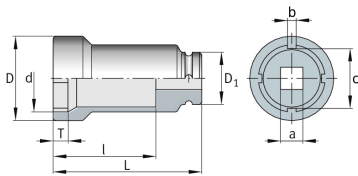

Medidas

d	45,5 mm	
D	53 mm	
D ₁	30 mm	
L	82 mm	
I	58 mm	
T	9 mm	
a	1/2"	Square (inch)
b	4,7 mm	
c	41,6 mm	
≈m	0,42 kg	Peso

Información adicional

KM6	Suitable for locknuts
ZMA25/45, ZM30	Suitable for precision locknuts
1 pc. socket wrench with locking pin and rubber washer	Included in delivery