**LFCL25**

Carro

hollow section carriage, clearance-free

## Información técnica

## Variante de su producto actual

Size code 25

## Medidas principales y datos de rendimiento

H<sub>1</sub> 30,5 mm

B 80 mm

L 110 mm

≈m 0,45 kg Peso

## Medidas de montaje

G<sub>4</sub> M6x10

H 32,1 mm Total height of carriage and rail at LFS, -C, -CE, -CEE, -E, -EE, -N, -NZZ

H 63,1 mm Total height of carriage and rail at LFS.-M

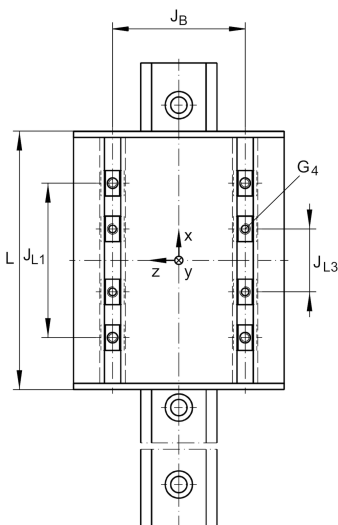
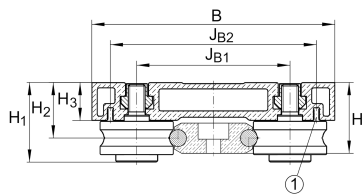
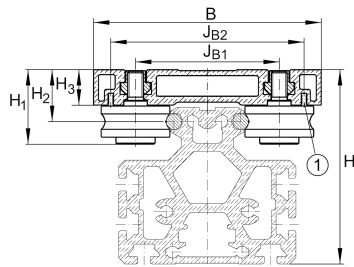
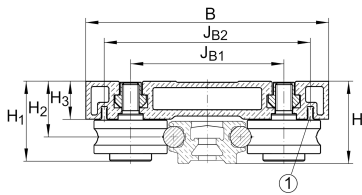
H<sub>2</sub> 21,5 mmH<sub>2</sub> Tol 0,3H<sub>2</sub> Tol 0H<sub>3</sub> 15,4 mmJ<sub>B</sub> 47 mmJ<sub>B1</sub> 47 mmJ<sub>B2</sub> 69 mmJ<sub>L1</sub> 58 mmJ<sub>L3</sub> max 32 mmJ<sub>L3</sub> min 13 mm

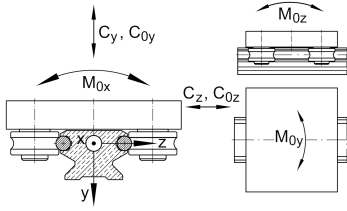

### Medidas principales

$C_y$	4.600 N	Basic dynamic load rating in y-direction
$C_{0y}$	2.400 N	Basic static load rating in y-direction
$C_z$	7.320 N	Basic dynamic load rating in z-direction
$C_{0z}$	4.500 N	Basic static load rating in z-direction
$M_{0x}$	25 Nm	Static moment about X-axis
$M_{0y}$	120 Nm	Static moment about Y-axis
$M_{0z}$	65 Nm	Static moment about Z-axis

### Productos relacionados

LFR	LFR50/8-6-2Z	Used track roller
LFS	LFS25	Guide rail