

LFCL42 [↗](#)

Carro

hollow section carriage, clearance-free

Información técnica

Variante de su producto actual

Size code 42

Medidas principales y datos de rendimiento

H 1	38,1 mm	
B	116 mm	
L	150 mm	
≈m	1 kg	Peso

Medidas de montaje

G 4	M8x12mm	
H	39 mm	Total height of carriage and rail at LFS, -C, -CE, -CEE, -E, -EE, -N, -NZZ
H	33,9 mm	Total height of carriage and rail at LFS.-M
H 2	26,4 mm	
H 2 Tol	0,3	
H 2 Tol	0	
H 3	18 mm	
J B	73 mm	
J B1	73 mm	
J B2	98,5 mm	
J L1	85 mm	
J L3 max	55 mm	
J L3 min	15 mm	

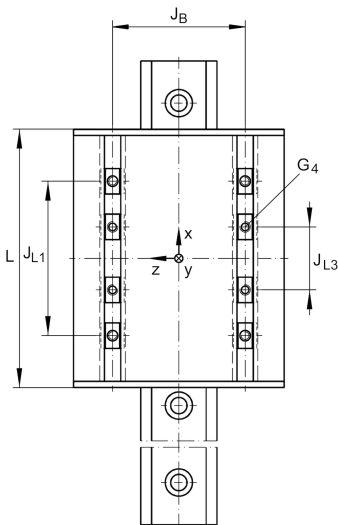
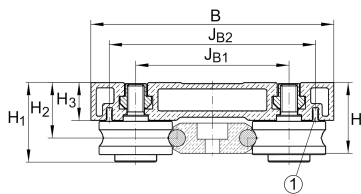
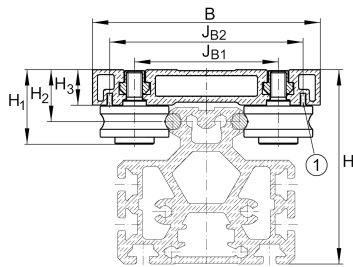
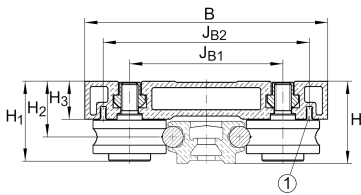

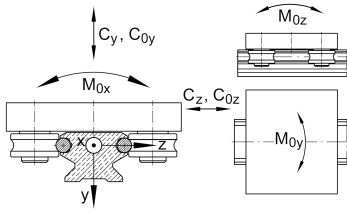

Medidas principales

C_y	10.200 N	Basic dynamic load rating in y-direction
C_{0y}	5.480 N	Basic static load rating in y-direction
C_z	16.900 N	Basic dynamic load rating in z-direction
C_{0z}	10.000 N	Basic static load rating in z-direction
M_{0x}	85 Nm	Static moment about X-axis
M_{0y}	425 Nm	Static moment about Y-axis
M_{0z}	230 Nm	Static moment about Z-axis

Productos relacionados

LFR	LFR5201-10-2Z	Used track roller
LFS	LFS42	Guide rail