

LFL20-SF [↗](#)

Carro

open carriage, standard design, clearance-free

Información técnica

Variante de su producto actual

Setting	SF	Clearance-free
---------	----	----------------

n.r.

	20	Size
≈m	0,16 kg	Peso

Medidas principales y datos de rendimiento

H ₁	20,5 mm
B	55 mm
L	50 mm

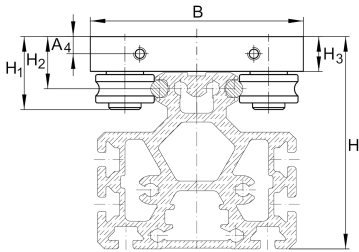
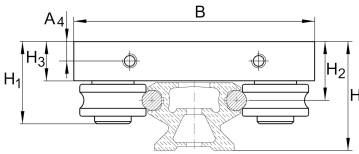

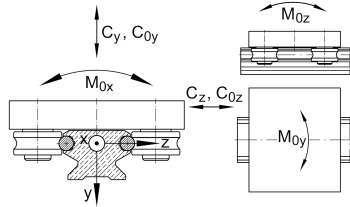
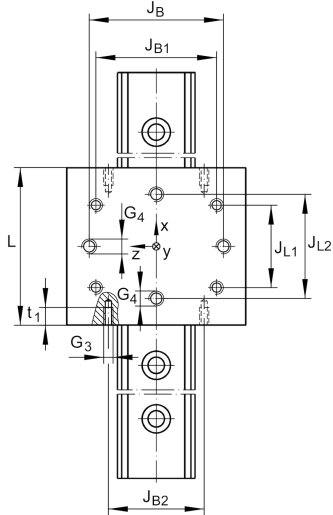

Medidas de montaje

G 3	M3	
G 4	M5	
H	22 mm	Total height of carriage and rail at LFS...F, -FE
H 2	13 mm	
H 2 Tol	0,3	
H 2 Tol	0	
H 3	9 mm	
J B	40 mm	
J B Tol	0,2	
J B Tol	-0,2	
J B1	34 mm	
J L1	24 mm	
J L2	38 mm	
J L2 Tol	0,2	
J L2 Tol	-0,2	

Medidas principales

M A	2,5 Nm	Tightening torque (standard version)
M A	2,5 Nm	Tightening torque (corrosion-resistant version)
C y	1.350 N	Basic dynamic load rating in y-direction
C 0y	870 N	Basic static load rating in y-direction
C z	2.400 N	Basic dynamic load rating in z-direction
C 0z	1.700 N	Basic static load rating in z-direction
M 0x	7 Nm	Static moment about X-axis
M 0y	20 Nm	Static moment about Y-axis
M 0z	10 Nm	Static moment about Z-axis



Ver detalles del producto en Medias

11.11.2025, 16:47:57 UTC

SCHAEFFLER

Productos relacionados

LFR	LFR50/5-4-2Z	Used track roller
LFS	LFS20	Guide rail