

LFL52-SF [↗](#)

Carro

open carriage, standard design, clearance-free

Información técnica

Variante de su producto actual

Setting	SF	Clearance-free
---------	----	----------------

n.r.

	52	Size
≈m	1,006 kg	Peso

Medidas principales y datos de rendimiento

H ₁	43,2 mm
B	120 mm
L	100 mm

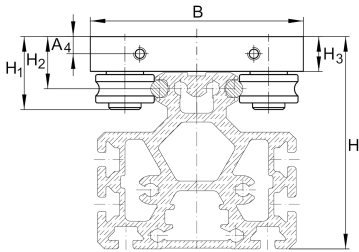
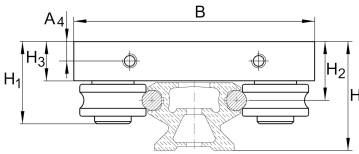

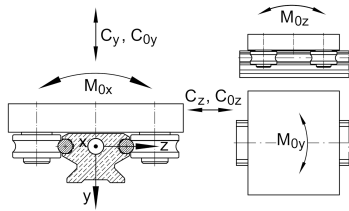
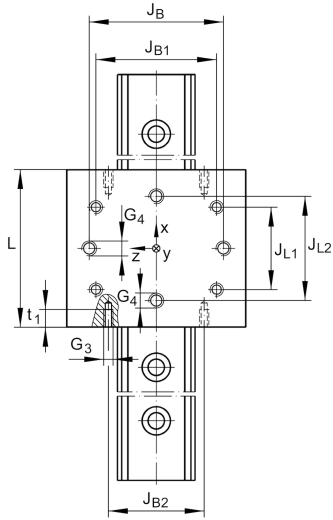
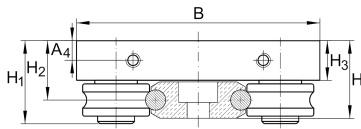

Medidas de montaje

A 4	9,75 mm	
G 3	M6	
G 4	M10	
H	54,3 mm	Total height of carriage and rail at LFS, -C, -CE, -CEE, -E, -EE, -N, -NZZ
H	38,2 mm	Total height of carriage and rail at LFS..-F, -FE
H	118,9 mm	Total height of carriage and rail at LFS..-M
H 2	29,2 mm	
H 2 Tol	0,3	
H 2 Tol	0	
H 3	19,5 mm	
J B	59 mm	
J B Tol	0,2	
J B Tol	-0,2	
J B1	83,2 mm	
J B2	65 mm	
J L1	60 mm	
J L2	70 mm	
J L2 Tol	0,2	
J L2 Tol	-0,2	
t 1	12 mm	



Medidas principales

M_A	40 Nm	Tightening torque (standard version)
M_A	23 Nm	Tightening torque (corrosion-resistant version)
C_y	10.000 N	Basic dynamic load rating in y-direction
C_{0y}	5.200 N	Basic static load rating in y-direction
C_z	16.800 N	Basic dynamic load rating in z-direction
C_{0z}	10.000 N	Basic static load rating in z-direction
M_{0x}	110 Nm	Static moment about X-axis
M_{0y}	290 Nm	Static moment about Y-axis
M_{0z}	150 Nm	Static moment about Z-axis

Productos relacionados

LFR	LFRI5201-10-2Z	Used track roller
LFS	LFS52	Guide rail