**LFS120**

Carril-guía

solid profile, with two raceway shafts;
corrosion-resistant design possible

Información técnica

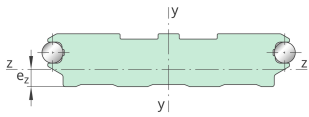
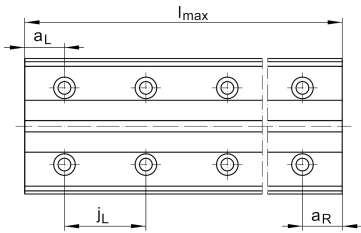
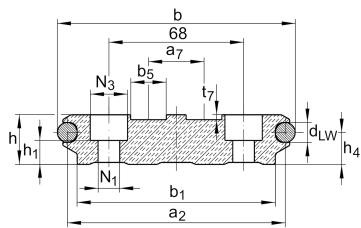

Variante de su producto actual

Size code	120
-----------	-----

Medidas principales y datos de rendimiento

h	25 mm	Height
b	120 mm	Width
l _{max}	8.000 mm	Length maximum
I _y	2.330.980 mm ⁴	Second moment of area
I _z	9.365 mm ⁴	Second moment of area
LF _Q	2.468 mm ²	Cross-sectional area
W _y	40.751 mm ³	Wider resistance torque
W _z	117.074 mm ³	Wider resistance torque

Medidas de montaje

N ₁	11 mm	Bore diameter
N ₃	19 mm	Bore diameter



Medidas

a ₂	110 mm	Distance
a ₇	28 mm	Distance
a _{L max}	235 mm	Distance
a _{L min}	17 mm	Distance
a _{R max}	235 mm	
a _{R min}	17 mm	
b ₁	100 mm	Anchura
b ₅	18 mm	Width
d _{LW}	10 mm	Diameter
e _Z	12,5 mm	Distance
h ₁	12 mm	Height
h ₄	16,1 mm	Height
j _L	250 mm	Increment
t ₇	2,5 mm	Depth