**TSX35-E-ADE**

Carril perfilado

Guideways for linear recirculating roller bearing, with slot for covering strip, TSX...-E-ADE

Información técnica

Variante de su producto actual

| | | |
|-----------------|-------|---|
| Size code | 35 | |
| Longitud | ~6000 | |
| Version | E | |
| Guideway design | ADE | For stainless steel cover strip, reusable, can be slid into place |

Medidas principales y datos de rendimiento

| | | |
|-------|-----------|---------------------|
| h | 30 mm | Altura |
| b | 34 mm | Anchura |
| Tol b | -0,005 mm | Tolerancia superior |
| Tol b | -0,035 mm | Tolerancia inferior |
| ≈m | 5,9 kg/m | Peso |

Medidas de montaje

| | | |
|--------|-------|---|
| K 1 | M8 | Tornillos de fijación (DIN ISO 4762-12.9) |
| d 1 | 9 mm | Diámetro del agujero |
| K1 M A | 41 Nm | Par de apriete |

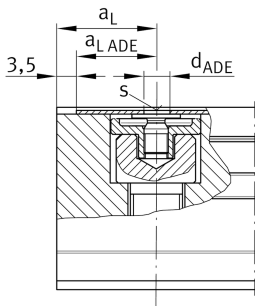
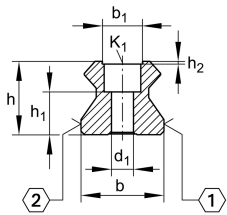
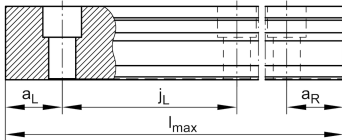

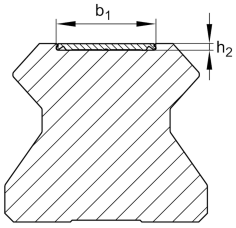

Medidas

| | | |
|-------------|----------|---------------------|
| l_{max} | 6.000 mm | |
| $a_{L min}$ | 20 mm | |
| $a_{L max}$ | 31 mm | |
| $a_{R min}$ | 20 mm | |
| $a_{R max}$ | 31 mm | |
| j_L | 40 mm | |
| h_1 | 17,5 mm | Longitud |
| Tol h_1 | 0,5 mm | Tolerancia superior |
| Tol h_1 | -0,5 mm | Tolerancia inferior |
| h_2 | 1,1 mm | Profundidad |
| b_1 | 17 mm | Anchura |
| d_{ADB} | 3,9 mm | Bore diameter |
| s | 0,6 mm | Thickness |

Información adicional

| | |
|------------------------------|--|
| RWU35-E-...; RWU35-F-... | utilizable para carros |
| RUE35-E-...; RUE35- F-... | utilizable para sistema de guiado lineal |