**TSX45-E-ADE**

## Carril perfilado

Guideways for linear recirculating roller bearing, with slot for covering strip, TSX...-E-ADE

## Información técnica

## Variante de su producto actual

|                 |       |   |
|-----------------|-------|---|
| Size code       | 45    |   |
| Longitud        | ~6000 |   |
| Version         | E     |   |
| Guideway design | ADE   | For stainless steel cover strip, reusable, can be slid into place |

## Medidas principales y datos de rendimiento

|       |           |                     |
|-------|-----------|---------------------|
| h     | 38 mm     | Altura              |
| b     | 45 mm     | Anchura             |
| Tol b | -0,005 mm | Tolerancia superior |
| Tol b | -0,035 mm | Tolerancia inferior |
| ≈m    | 9,4 kg/m  | Peso                |

## Medidas de montaje

|        |         |   |
|--------|---------|---|
| K 1    | M12     | Tornillos de fijación (DIN ISO 4762-12.9) |
| d 1    | 13,4 mm | Diámetro del agujero                      |
| K1 M A | 140 Nm  | Par de apriete                            |

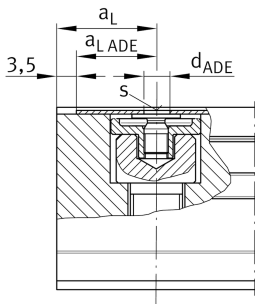
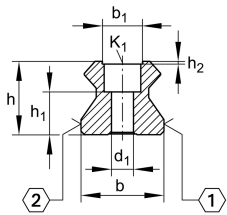
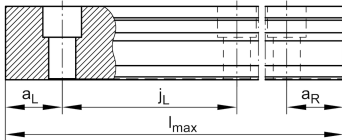

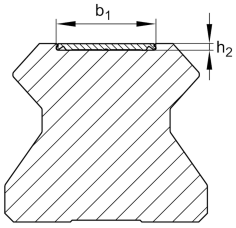

### Medidas

|             |          |                     |
|-------------|----------|---------------------|
| $l_{max}$   | 5,985 mm |                     |
| $a_{L min}$ | 20 mm    |                     |
| $a_{L max}$ | 41 mm    |                     |
| $a_{R min}$ | 20 mm    |                     |
| $a_{R max}$ | 41 mm    |                     |
| $j_L$       | 52,5 mm  |                     |
| $h_1$       | 19,5 mm  | Longitud            |
| Tol $h_1$   | 0,5 mm   | Tolerancia superior |
| Tol $h_1$   | -0,5 mm  | Tolerancia inferior |
| $h_2$       | 1,1 mm   | Profundidad         |
| $b_1$       | 22 mm    | Anchura             |
| $d_{ADB}$   | 3,9 mm   | Bore diameter       |
| $s$         | 0,6 mm   | Thickness           |

### Información adicional

|                              |  |
|------------------------------|--|
| RWU45-E-...;<br>RWU45-F-...  | utilizable para carros                   |
| RUE45-E-...; RUE45-<br>F-... | utilizable para sistema de guiado lineal |