**KTSS30-PP-AS** [↗](#)

Unidad de rodamiento lineal de bolas

Linear ball bearing and housing unit;
adjustable clearance, with self-aligning linear
ball bearing, contact seals on both sides

Información técnica

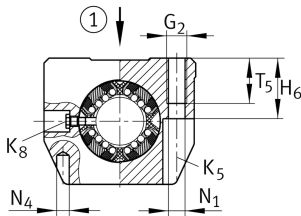
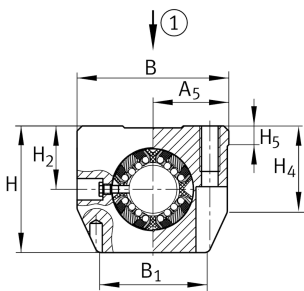

Variante de su producto actual

Size code	30
Seal	PP
Función de relubricación	AS

Medidas principales y datos de rendimiento

F _W	30 mm	Diameter of ball complement
H	70 mm	Height
L	142 mm	Longitud
B	87 mm	Anchura
C _{max}	9.600 N	Load capacity dyn.
C _{0 max}	12.000 N	Load capacity stat.
≈m	1,7 kg	Peso



Medidas de montaje

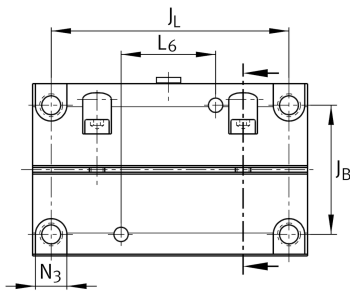
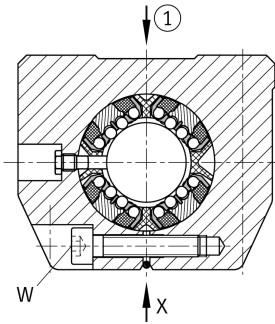
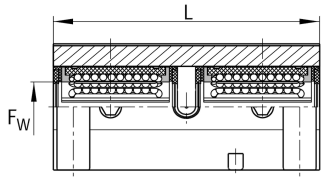

J_B	68 mm	
Tol J_B	+ 0,15 mm	Upper tolerance
Tol J_B	- 0,15 mm	Lower tolerance
B_1	63 mm	
A_5	43,5 mm	
Tol A_5	+ 0,01 mm	Upper tolerance
Tol A_5	- 0,01 mm	Lower tolerance
J_L	106 mm	Distance
Tol J_L	+ 0,15 mm	Upper tolerance
Tol J_L	- 0,15 mm	Lower tolerance
L_6	54 mm	Distance
H_2	35 mm	Center height
Tol H_2	+ 0,008 mm	Upper tolerance
Tol H_2	- 0,016 mm	Lower tolerance
H_4	46,2 mm	
H_5	9,3 mm	
T_5	22 mm	
H_6	34 mm	
G_2	M10	
N_1	8,4 mm	
N_4	6 mm	
N_3	15 mm	
K_5	M8	
K_8	NIP5MZ	Lubrication nipple
W	5 mm	Width across flats
	8	Ball rows