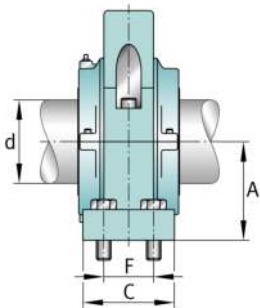
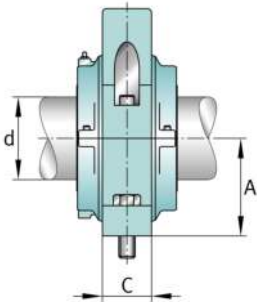

**FAG****S1SNLH-110MM-FL-2B** [↗](#)

Soporte de apoyo

FAG split cylindrical roller bearing housing

## Información técnica

**Medidas principales y datos de rendimiento**

d	110 mm	Diámetro del eje
H	≈ 311,15 mm	Housing height
A	≈ 139,7 mm	Center height
B	≈ 409,575 mm	Length Base
≈m	49,895 kg	Peso

**Medidas**

	S1SNLH-110MM-HD-2B	Complete unit held
	S1SNLH-110MM-FL-2B	Complete unit float
	SNLH-7-2B	Housing designation
D	≈ 39,688 mm	Base height
C	≈ 73,025 mm	Base width
E	≈ 352,425 mm	Base hole distance 1
S	2	# of Mounting Bolts
S	≈ 25,4 mm	Mounting bolt diameter